



TrueDRY™ DR90

Ventilating Dehumidification System

SPECIFICATION DATA

DR90 Capacities and Performance

Part Number:	DR90A2000
Blower:	262 CFM @ 0.0 in. WG 106 CFM @ 0.6 in. WG
Supply Voltage:	120 VAC; 60 Hz.
Amps:	5.9 A
Power transformer to R/C terminals:	24 VAC, 0.85A
Energy performance:	2.9 liters (6.1 pints) per kilowatt hour (KWH) Energy
Refrigerant:	R-410A
Operating Temp Range (outside cabinet):	34 – 135 °F (1.1 – 57.2 °C)
Capacity:	54 pints/day (60 °F [15.6 °C], 60 %RH) 73 pints/day (70 °F [21.1 °C], 60 %RH) 90 pints/day (80 °F [26.7 °C], 60 %RH)
Coverage:	Up to 2800 sq. ft.
Duct Connections:	6 in. Supply Inlet 10 in. Round Inlet 10 in. Round Outlet (ABS Plastic)
Filter Efficiency:	Standard MERV-11
Drain Connection:	3/4 in. threaded female NPT, with attached 3/4 in. threaded male NPT

Dimensions (See Fig. 1):

Width:	14-3/8 in.
Height:	19-3/8 in.
Length:	25-13/16 in. (without collars) 32-3/16 in. (with collars)
Weight:	82 lbs (37.2 Kg)

Shipping Specs

Width:	18-1/2 in.
Height:	21-1/2 in.
Length:	40 in.
Weight:	93 lbs (42.2 Kg)

Optional Parts

Replacement Filter	50070171-002
Motorized Ventilation Damper	EARD6
Bypass Damper	CPRD10
Compressor Relay, 24 VAC, 30 A	50035445-014
Compressor Run Capacitor	50070171-001
10" Duct Collar	50049536-005
Fan Assembly	50049537-006/ DR90XFAN1
Capacitor - Fan	50070204-001/ DR90XCFA1
Fan Relay, SPDT, 24 VAC, 15A	50035445-011
Transformer 120/24 VAC, 40 VA	50035445-013
Defrost Thermostat	50070204-002

ETL Listed. Energy Star Rated. Conforms to UL standard 60335-2-40.

For more information call 1-800-468-1502 or visit our website at customer.honeywell.com.

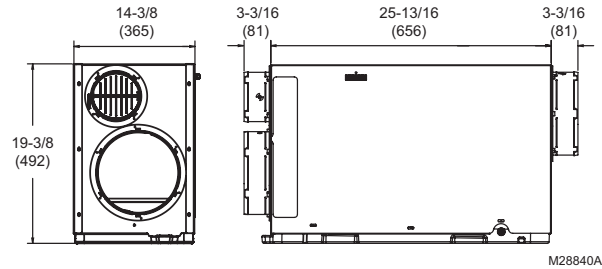

Fig. 1. Dimensions in in. (mm).

TrueDRY Whole-House Dehumidifiers are designed to help maintain proper humidity levels in the home. Lower humidity levels feel more comfortable, and helps safeguard against problems from excess moisture in the home such as mold, mildew, warped wood, peeling of paint, or musty odors. Honeywell TrueDRY Whole Home Dehumidification Systems are Energy Star rated providing efficient and economical operation.

Dehumidification

The TrueDRY DR90 dehumidifier utilizes refrigeration and internal air circulation to cool the incoming air stream below its dew point. Water condenses and drains off the coil, sending drier air back into the house.

- Can remove up to 90 pints/day of moisture.
- Energy Star rated
- Electrocoating reduces coil corrosion and helps prevent refrigerant leaks
- Top or side ducted exhaust
- Reduced noise during operation
- MERV 11 air filtration

Ventilation

The TrueDRY DR90 has a separate control for ventilation, so the powerful onboard blower can be used to efficiently bring fresh air into the house even when dehumidification is not needed. The TrueDRY DR90 has a 6" supply side damper that can be used to duct in air from the outside, or closed if not needed.

Simplified Wiring

The TrueDRY DR90 dehumidifiers can be controlled by a variety of 24-volt remote wired and wireless controls.

The TrueDRY DR90 allows the use of a 24V normally closed float switch or water sensor to simplify installation in a drain pan. This will allow the external float switch to kill power to the compressor in the event of water blockage.



Installation Recommendations and Options

A

Dedicated Return to Main Supply

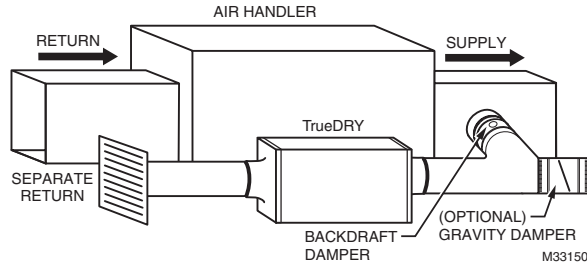

Ideal when...

- Access to a dedicated central return for TrueDRY DR90 is available.
- Combined with A/C operation; requires backdraft damper on the exhaust port to minimize backdraft when TrueDRY DR90 is not on but A/C is.
- Providing dry air to a specific area with an optional 20% open gravity damper on TrueDRY DR90 supply.

B

Main Return to Main Supply

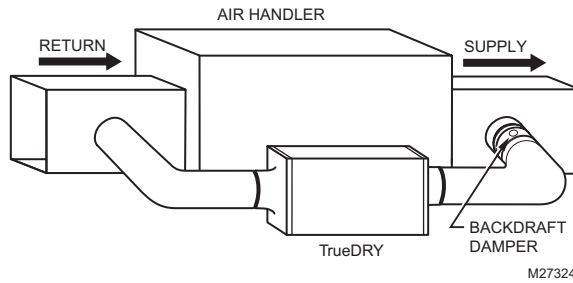

Ideal when...

- Running TrueDRY DR90 when not running A/C. Requires damper on the exhaust port to minimize backdraft when TrueDRY DR90 is not on but A/C is.
- Access to a dedicated central return for TrueDRY DR90 is not available.
- System fan should run with dehumidifier for best results.

C

Main Return to Main Return

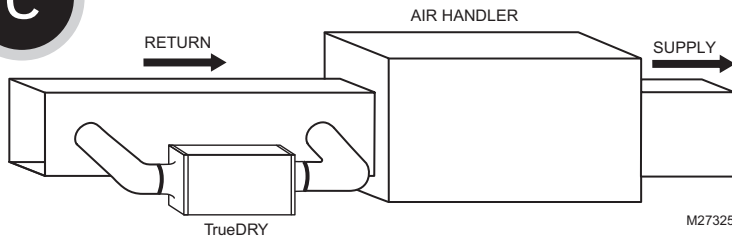

Ideal when...

- Running TrueDRY DR90 with A/C operation.
- System fan must run with dehumidifier.
- Minimizing discharge air temperature (DAT) increase is preferred.
- Access to a dedicated central return for TrueDRY DR90 is not available.

D

Dedicated Return to Dedicated Supply

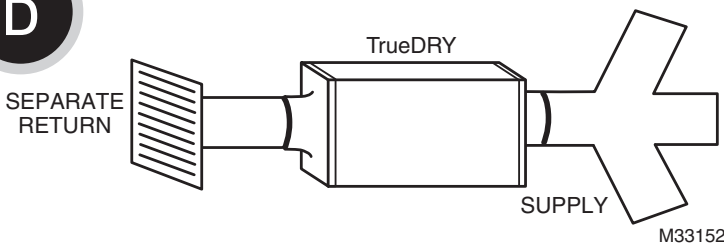

Ideal when...

- TrueDRY DR90 will not be ducted to a forced air HVAC system.



1. Never operate a unit with a damaged power cord. If the power cord is damaged it must be replaced by the manufacturer, its service agent, or similarly qualified person in order to avoid a hazard.
2. The appliance is not intended for use by persons (including children) with reduced physical, sensory, or mental capabilities, or lack of experience and knowledge, unless they have been given supervision or instruction concerning use of the appliance by a person responsible for their safety. Children should be supervised to ensure that they do not play with the appliance.



www.resideo.com

Resideo Technologies, Inc.
1985 Douglas Drive North, Golden Valley, MN 55422
1-800-468-1502
68-3087-05 M.S. Rev. 07-21 | Printed in United States

© 2020 Resideo Technologies, Inc. All rights reserved.

The Honeywell Home trademark is used under license from Honeywell International, Inc. This product is manufactured by Resideo Technologies, Inc. and its affiliates.